

# MARINA RST

IP65 IK10



-O-  
5 x 2,5

DALI

ta  
35 °C



TEOLLISUUSVALAISIN SULJETTU | KAPSLAD INDUSTRIARMATUR | SEALED INDUSTRIAL LUMINAIRE

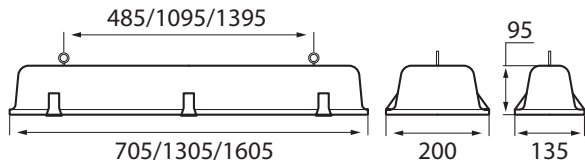

	A	C	D
1.2ft	705	135	485
1.4ft	1305	135	1095
1.4ft HORTI	1305	135	1095
1.5ft	1605	135	1395
2.2ft	705	200	485
2.4ft	1305	200	1095
2.5ft	1605	200	1395

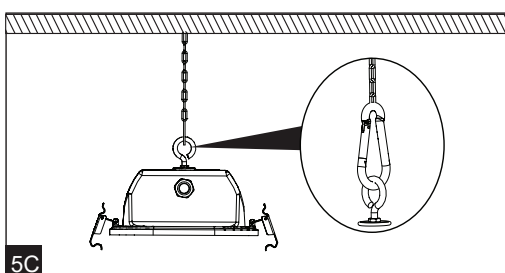
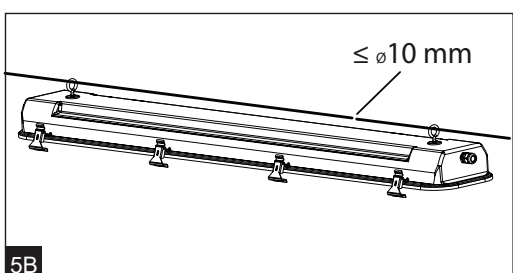
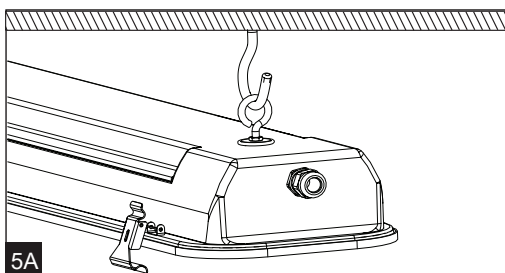
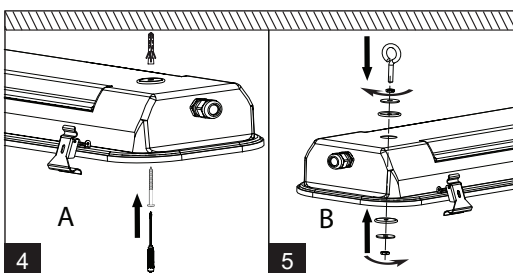
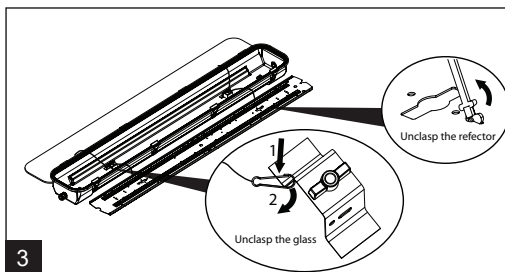
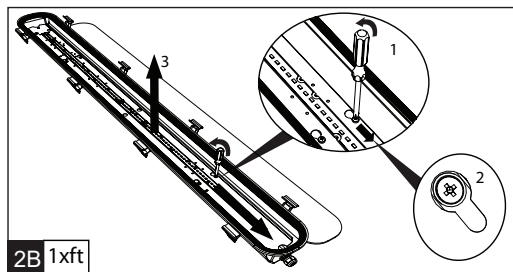
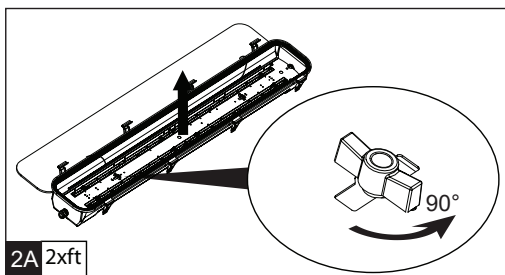
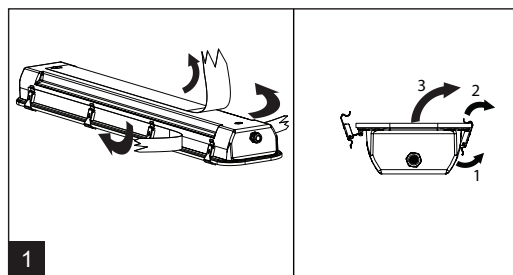
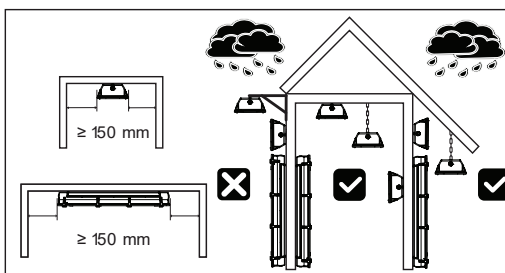

Valaisimen saa asentaa vain sähköalan ammattilainen. Käytä ainoastaan syöttöjännitettä ja taajuutta joka on merkitty valaisimeen/liitäntälaitteeseen. Kytke virta pois päältä ennen asennusta tai huoltoa. Tämä asennusohje on säilytettävä ja sen on oltava käytössä asennuksessa ja huollossa. Tämän valaisimen valonlähde ei ole vaihdettavissa. Kun valonlähde rikkoutuu, koko valaisin on poistettava käytöstä.

Vi rekommenderar att installationen görs av en behörig elektriker. Använd endast driftspänning och frekvens som är märkt på armaturen/förkopplingsdonet. Bryt stömmen före installation eller service. Denna monteringsanvisning bör sparas och finnas tillgänglig vid installation eller framtida service. Ljuskällan till denna armatur kan inte bytas ut. När ljuskällan når sin livslängd ska hela armaturen bytas ut.

Only a professional electrician is allowed to do the installation. Use only rated voltage and frequency as marked in the fixture/driver. Switch off the current before installation or service. This mounting instruction must be kept available during installation and for future maintenance. The light source of this luminaire is not replaceable; when the light source reaches its end of life the whole luminaire shall be replaced.

# MARINA RST

IP65 IK10



-O-  
5 x 2,5

DALI

ta  
35 °C



TEOLLISUUSVALAISIN SULJETTU | KAPSLAD INDUSTRIARMATUR | SEALED INDUSTRIAL LUMINAIRE

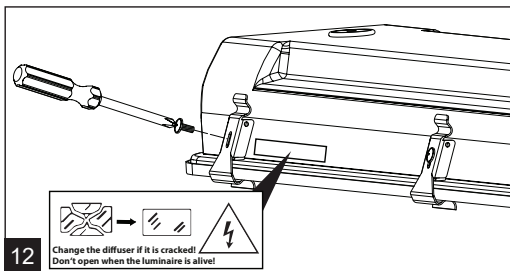
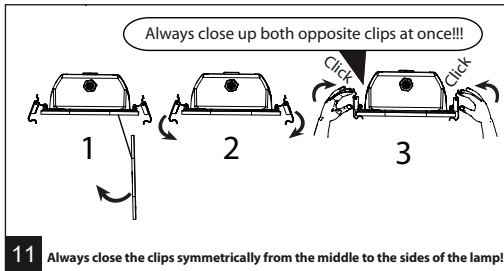
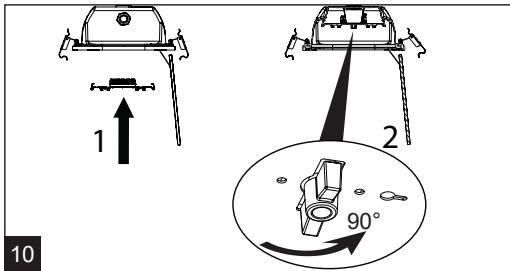
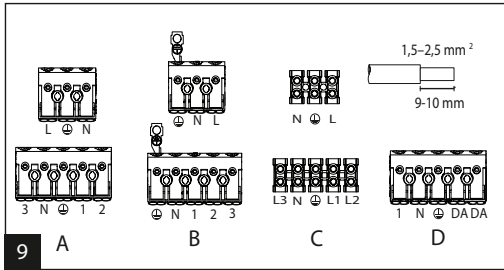
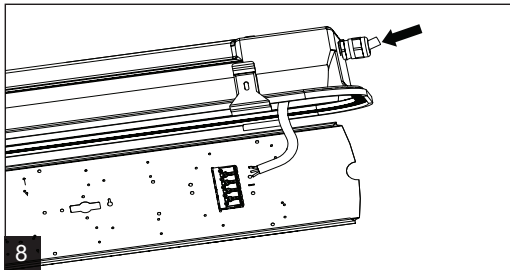
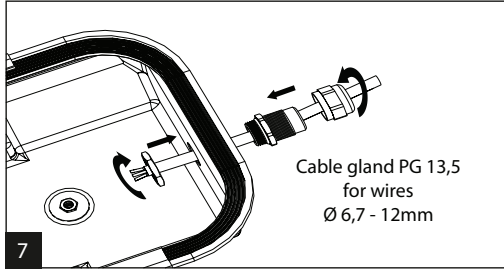
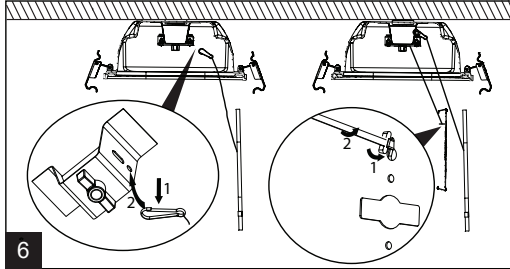

Length	10A B			10A B	16A B	10A C	16A C
	Σ1m	Σ1m	Σ1m	Σ luminaires	Σ luminaires	Σ luminaires	Σ luminaires
1.2ft	1300	1600	2200	32	50	52	85
1.4ft	2600			32	50	52	85
1.4ft	3200	4400		10	16	16	26
1.4ft HORTI				6	10	10	17
1.5ft	3250	4000	5500	10	16	16	26
2.2ft	2600			32	50	52	85
2.2ft	3200	4400		10	16	16	26
2.4ft	5200	6400	8800	10	16	16	26
2.5ft	6500	8000	11000	10	16	16	26

## Huolto- ja kierrätysohjeet

## Underhålls- och återvinningsinstruktioner

## Hooldus- ja utiliseerimisjuhend

## Maintenance and recycling instructions

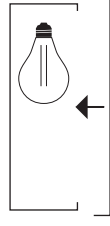
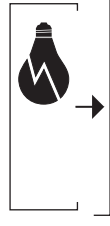
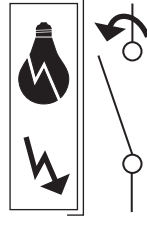
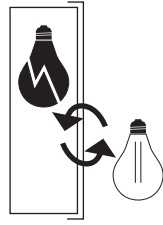
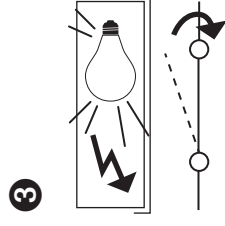
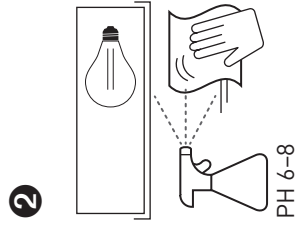
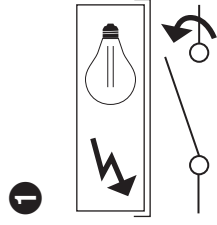
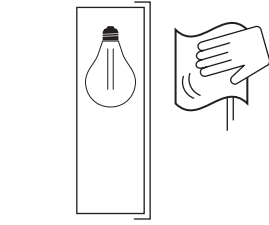
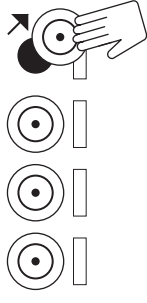
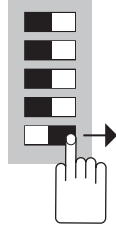
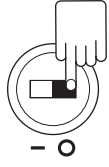
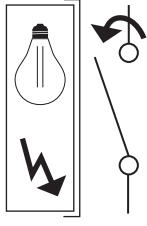

1

2

3

4

Odota, että valaisin on  
jäähdytynyt.  
Väntä tälls lampan har svalnat.  
Oodake, kuni valgusti on  
jähtunud.  
Wait until the luminaire has  
cooled down.

